

standard design

- wetted material: 316L SS, fused borosilicate glass duplex SS
- plastic handle with stainless steel sleeve
- silicone seal (blue)
- with hinge and knob
- flange 50mm high, 10mm thick, outside in conical shape
- surface unground, pickled

options

- wetted materials: HC-22, HC-276, HC-2000, Alloy 304L, 316LN SS, etc.
- fused glass: ring: HC-22, HC-276
glass: quartz glass, sapphire glass
- intermediate sizes possible
- variety of seal materials (see p.14-15)
- surface finishes: shot blasted, ground up to 500 grit
- various handles and screws: stainless steel handle, wing-nut, collar nut, etc. (see p.25)
- locking pin (see p.25)
- spring assist (torsionsprings) (see p.25)
- various limit switches
- safety grill / safety cross
- non-wetted: metal parts in different materials
- wipers and/or lights

advantages

- glass cover blow-out resistant and shatter-resistant
- seal is built in the upper flange, and is not exposed
- wetted surfaces are easily cleaned

fused glass cover - Pharma

up to 10/-1bar

with ASME approval (optional)

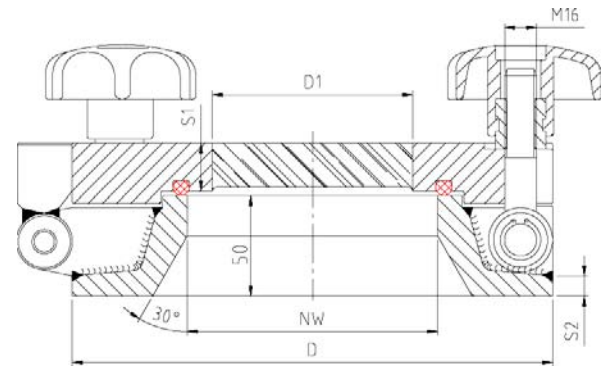

model #	size ID (mm)	max. allowed working pressure in bar	max. allowed working temp in °C	number of screws M16	thickness of glass (mm)	thickness of flange S2 (mm)	outside diameter D (mm)	viewing D1 (mm)	weight in kg
221 000 FLANGE	100	10 bar	280 °C	4	24	10	215	80	14
221 250 FLANGE	125	10 bar	280 °C	4	24	10	240	100	15
221 500 FLANGE	150	10 bar	280 °C	4	24	10	265	125	15
221 750 FLANGE	175	10 bar	280 °C	4	24	10	290	150	16
222 250 FLANGE	225	10 bar	280 °C	4	24	10	340	175	19

Archon Industries, Inc. tel: (845) 368-3600
 357 Spook Rock Road fax: (845) 368-3040
 Suffern, NY 10901
 USA info@ARCHONind.com